

# BERTSCHlaska

Machinery and equipment  
for the food industry

90  
JAHRE

TRADITION  
QUALITÄT  
KNOW-HOW  
SEIT 1925

## Meat and sausage production plant

HEILONG JING BOTAO FOOD, People's Republic of China



**BERTSCH**

TRADITION, QUALITY, KNOW-HOW. SINCE 1925

# Meat and sausage production plant

## Capacity: 30 tons per shift

## Factory area: 4.500 m<sup>2</sup>

Project HEILONG JING BOTAO FOOD

### PROJECT PLANNING (GREEN FIELD)

- » Project study
- » Technological project planning
- » Continuous project support

### SCOPE OF DELIVERY (EQUIPMENT)

- » RAILWAY TECHNOLOGY
  - Defrosting room
  - Cold-storage rooms for cattle and pig carcasses
  - Railway technology at loading and deboning area
- » DELICACIES PREPARATION
  - Injector, Vacuum tumbler, etc.
- » SAUSAGE PRODUCTION
  - Scale ice machine, angle mincer, cutter, mixing machine, etc.
- » THERMAL SECTION
  - Smoke, cooking, roasting, intensive cooling and post-maturing systems
- » HYGIENIC EQUIPMENT
  - Hygiene locks, knife steriliser , etc.

### INSTALLATION AND COMMISSIONING

- » Chef assembly including technological process support
- » Technical and technological personnel training

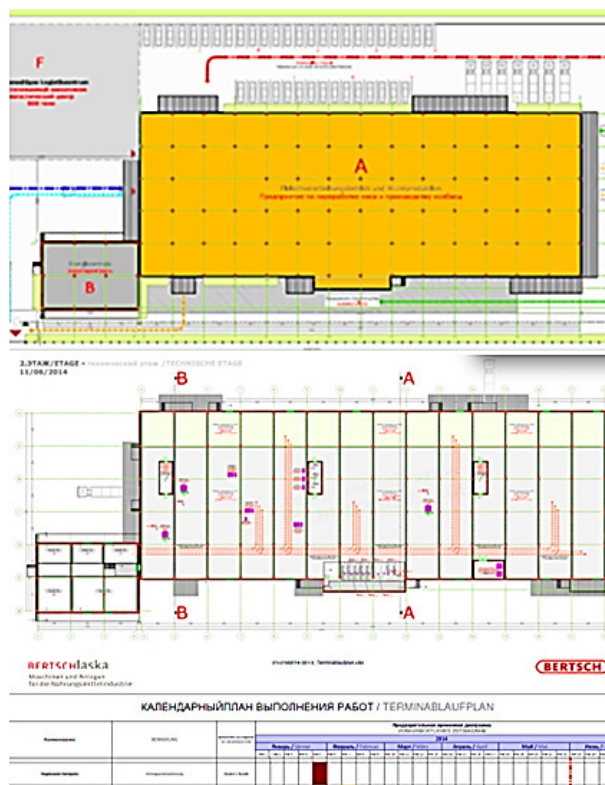

Layout



Sausage production



Refrigeration systems



Thermal section